

D75 SERIES Part Circle Golf Rotor

NOZZLE INSTALLATION GUIDE

STEP 1: REMOVE DRIVE ASSEMBLY

STEP 2: INSTALL NEW NOZZLE

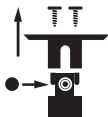

- Remove screws (2) on top of nozzle cap.
- Pull off nozzle cap.
- Snap in correct nozzle.
(see Performance Chart).
- To remove nozzle, pull out using snap ring tool or screwdriver.

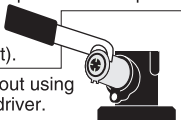

STEP 3: INSTALLING ASSEMBLY

- Place assembly in body.
- Install snap ring.
- Reinstall nozzle cap with screws (2).

IMPORTANT: Tighten screws securely.

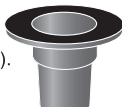

ADJUSTABLE PART CIRCLE ADJUSTMENT

STEP A: ROTATE EASY ARC TABS TO DESIRED ARC

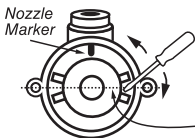

- Rotor must be OFF
- Remove EASY ARC Cap
- Using a small screwdriver or pointed object, move right and left tabs on each side of the Nozzle Marker.
Example: 180°
- Replace EASY ARC Cap



NOTE: Make sure nozzle faces area to be irrigated.

75-Series Performance Data (U.S.)

	#32 YELLOW		#36 GRAY		#41 ORANGE	
Base Pressure (psi)	Radius (ft)	Flow (gsm)	Radius (ft)	Flow (gsm)	Radius (ft)	Flow (gsm)
60	67	27.5	67	28.0	65	32.3
70	69	29.3	69	32.2	71	34.5
80	69	31.6	69	34.0	73	37.7
90	71	33.1	73	36.5	73	39.9

75-Series Performance Data (Metric)

	#32 YELLOW			#36 GRAY			#41 ORANGE		
Base Pressure (bars)	Radius (m)	Flow (l/s)	Flow (m³/hr)	Radius (m)	Flow (l/s)	Flow (m³/hr)	Radius (m)	Flow (l/s)	Flow (m³/hr)
4,1	20.4	1.7	6.2	20.4	1.8	6.4	19.8	2.0	7.3
4,8	21.0	1.8	6.6	21.0	2.0	7.3	21.6	2.2	7.8
5,5	21.0	2.0	7.2	21.0	2.1	7.7	22.2	2.4	8.6
6,2	21.6	2.1	7.5	22.2	2.3	8.3	22.2	2.5	9.1